



ANTONINI  
NAVI





SOLD UNDER CONSTRUCTION  
EVO-31 EXPLORER



# EVO-31 EXPLORER CONCEPT

---



The Explorer "EVO" is designed with Hydro Tec's experience in creating compact explorer yachts whilst developing an evolved and elegant exterior.





EVO-31 EXPLORER

# STRENGTHS

---

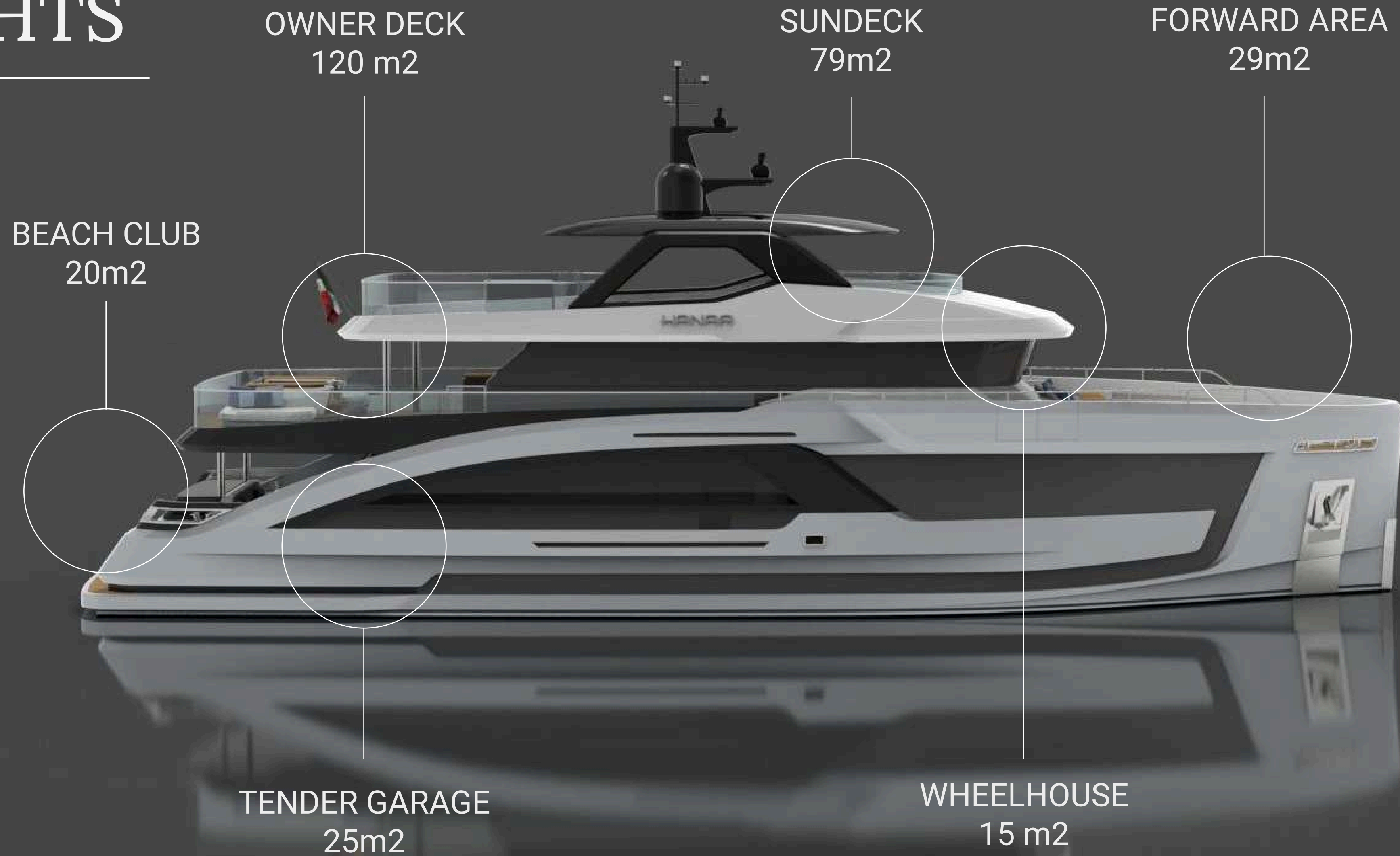





SUN DECK





MAIN DECK AFT COCKPIT



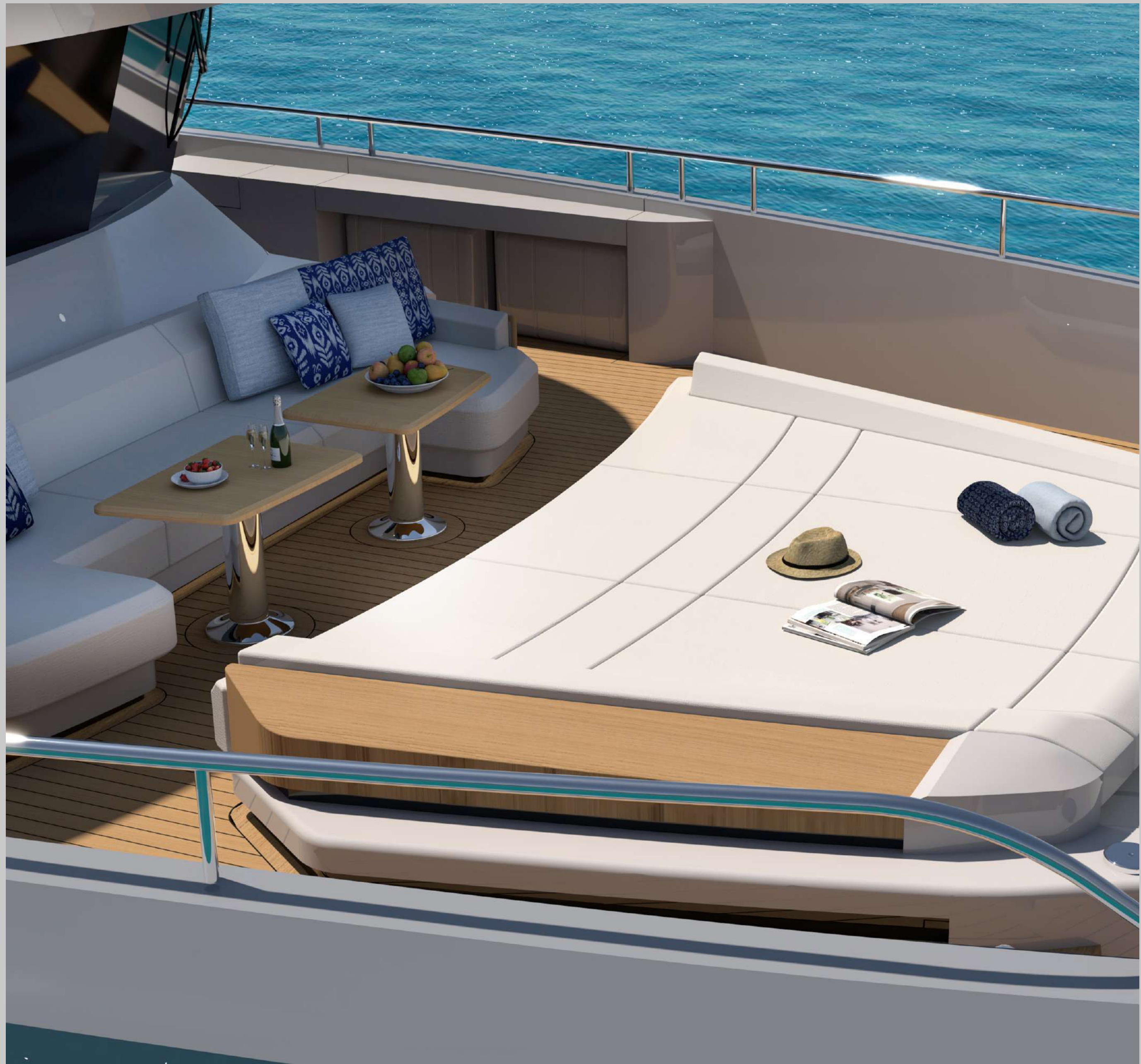

OWNER DECK







OWNER DECK





BEACH CLUB





INTERIOR DESIGN





MAIN SALOON





MAIN SALOON







MASTER CABIN





MASTER  
CABIN

INTERIOR DESIGN | HOT LAB





TWIN DOUBLE CABIN





TWIN DOUBLE CABIN

INTERIOR DESIGN | HOT LAB





VIP CABIN

INTERIOR DESIGN | HOT LAB









TWIN CABIN





TWIN CABIN

INTERIOR DESIGN | HOT LAB





DINING ROOM





DINING ROOM

INTERIOR DESIGN | HOT LAB























EVO-31 EXPLORER

# TECHNICAL SPECIFICATION

---

## MATERIALS

Hull: ..... Steel

Superstructure: ..... Aluminium

## DIMENSIONS

Length over all (LOA): ..... 31.2 m

Length waterline (LWA): ..... 30.5 m

Maximum beam: ..... 7.5 m

Depth, amidship: ..... 4.0 m

Draught, full load under the keel: ..... 2.4 m

GROSS TONNAGE: ..... <300 GT

## CAPACITIES

Marine Gas Oil: ..... 42.0 m<sup>3</sup>

Fresh Water: ..... 6.0 m<sup>3</sup>

Black Water: ..... 1.0 m<sup>3</sup>

Bilge: ..... 0.5 m<sup>3</sup>

Pool tank: ..... 1.5 m<sup>3</sup>

## PERFORMANCE

Cruising speed: ..... 12.0 kts

Max Speed: ..... 13.0 kts

Range @10 kts: ..... 4.000 Miles

PROPULSION: ..... 2xCat C18 2x533kW@1800-2100rpm

## ACCOMMODATION

Passenger capacity: ..... 10 + 2

Crew capacity: ..... 5 + 1



EVO-31 EXPLORER  
**GENERAL  
ARRANGEMENT**

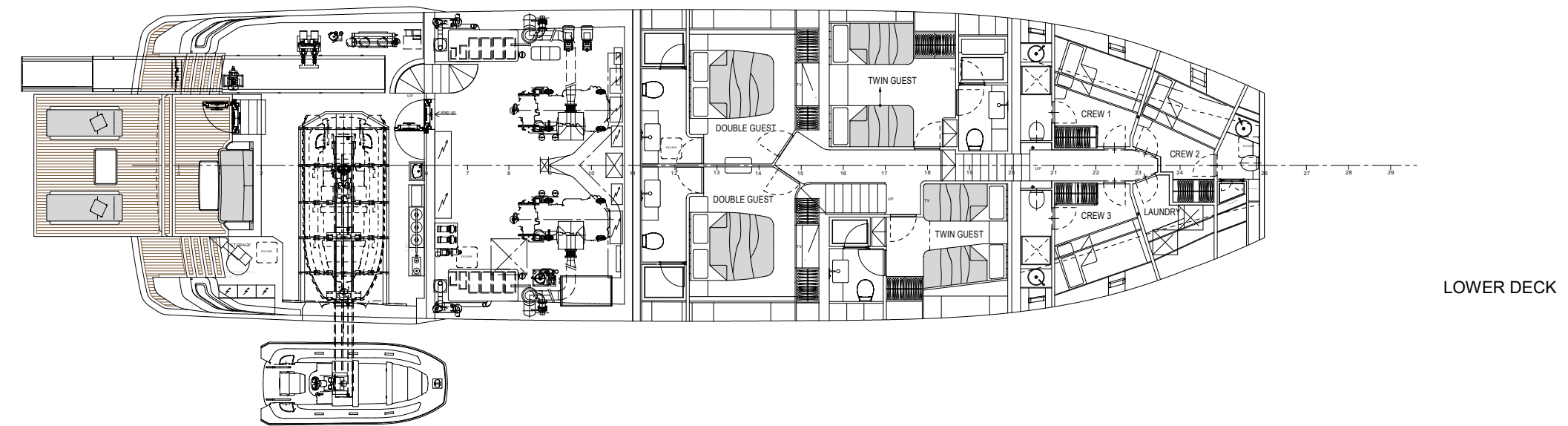
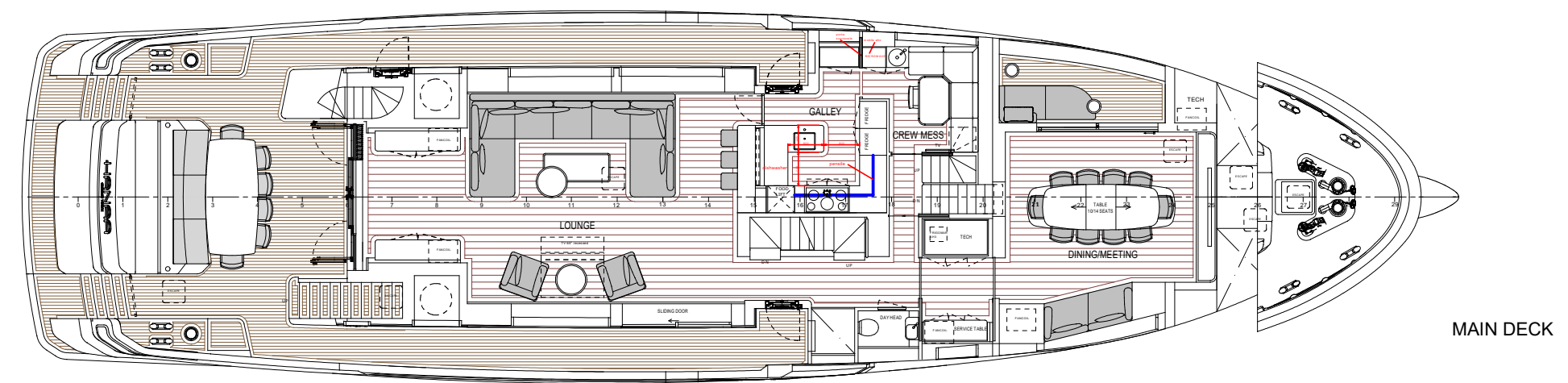
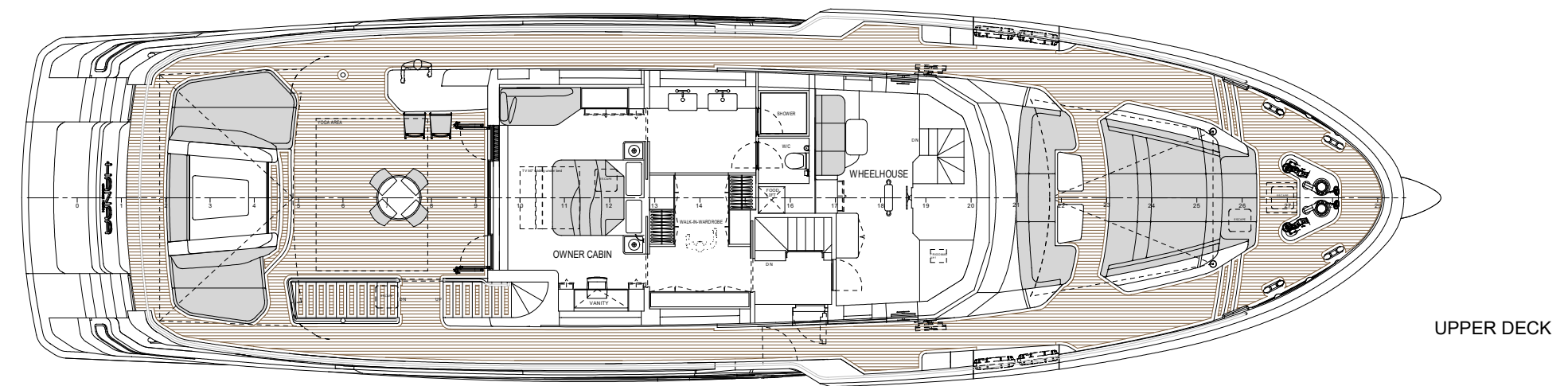
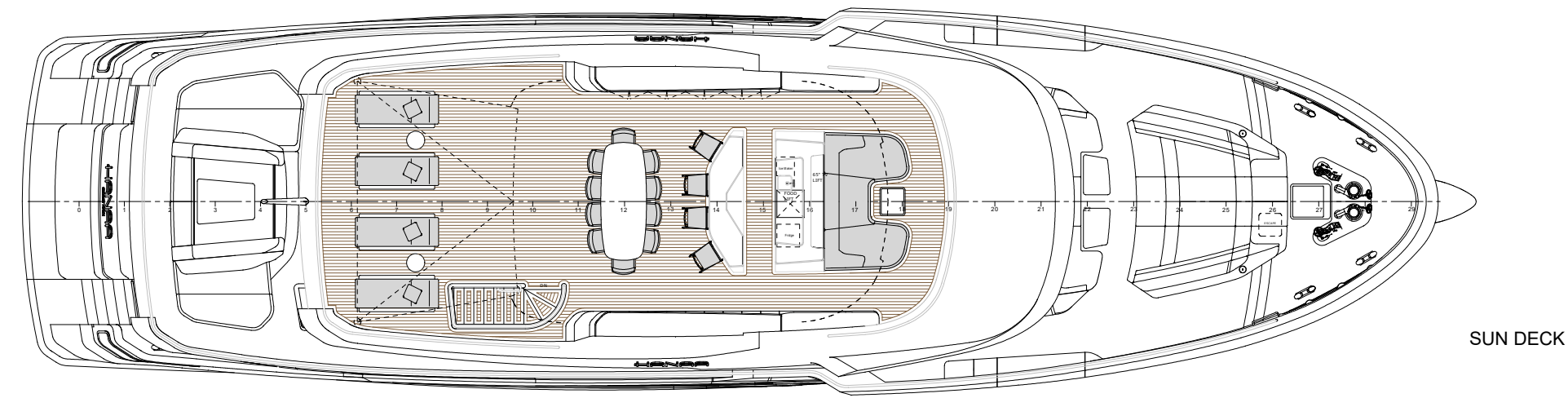



EVO-31 EXPLORER

# SUN DECK | BRIDGE DECK

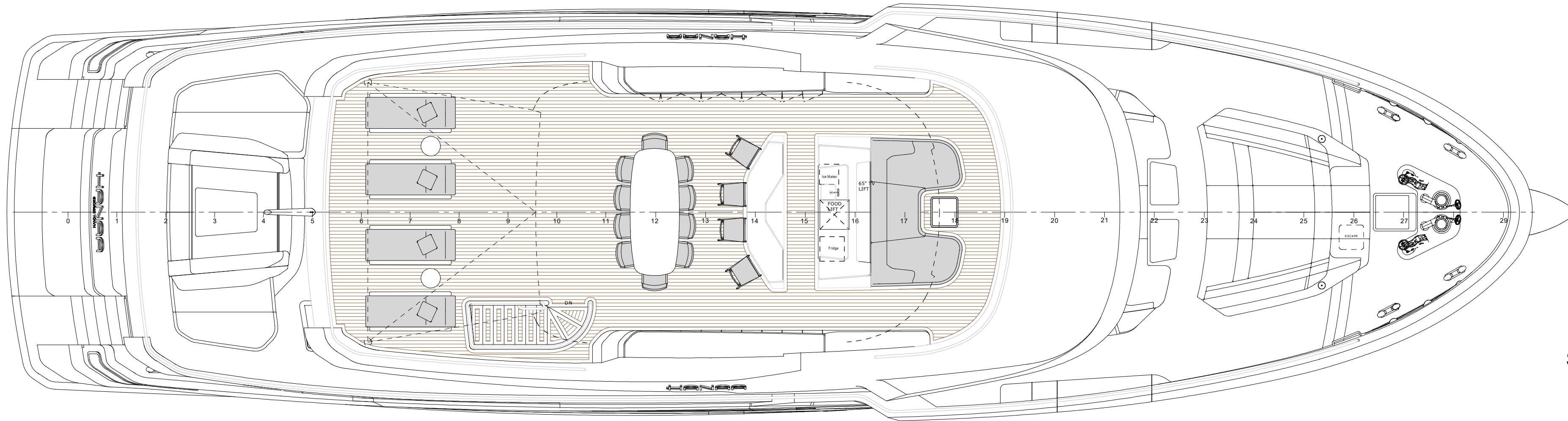

SUN DECK



# EVO-31 EXPLORER

## UPPER DECK

---

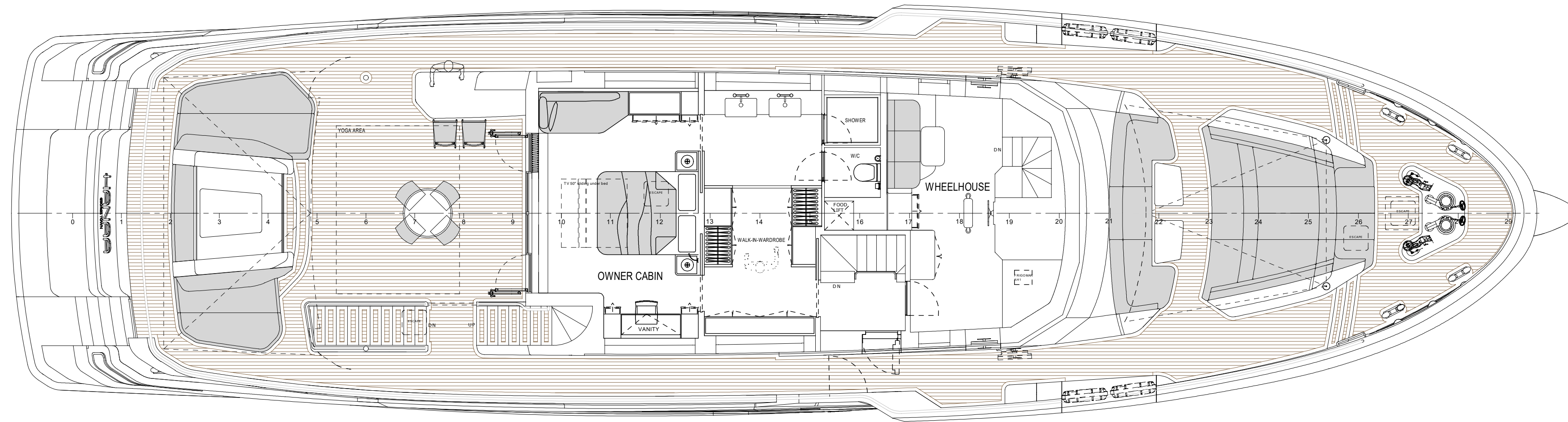

UPPER DECK



# EVO-31 EXPLORER MAIN DECK

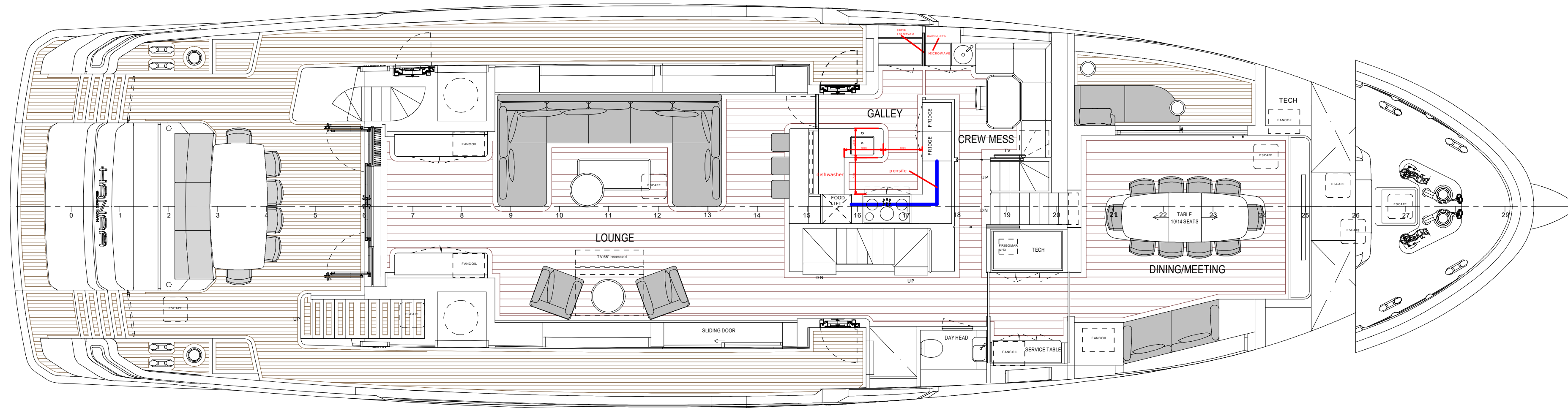

MAIN DECK



# EVO-31 EXPLORER

## LOWER DECK

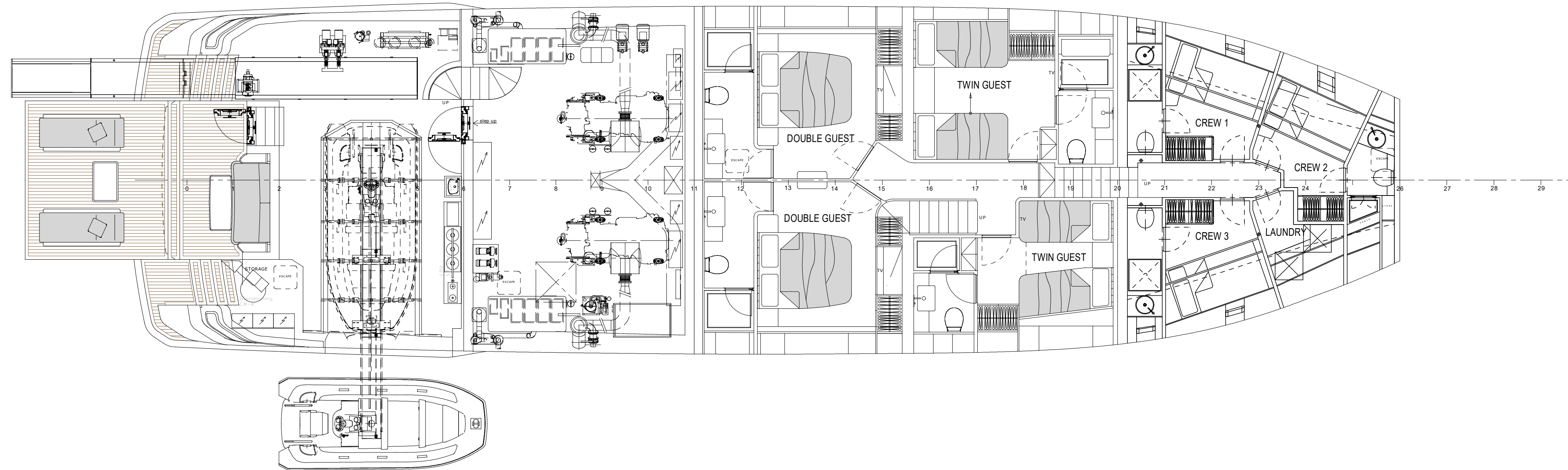

LOWER DECK





SOLD UNDER CONSTRUCTION  
**EVO-31 EXPLORER**





SOLD UNDER CONSTRUCTION

# EVO-31 EXPLORER



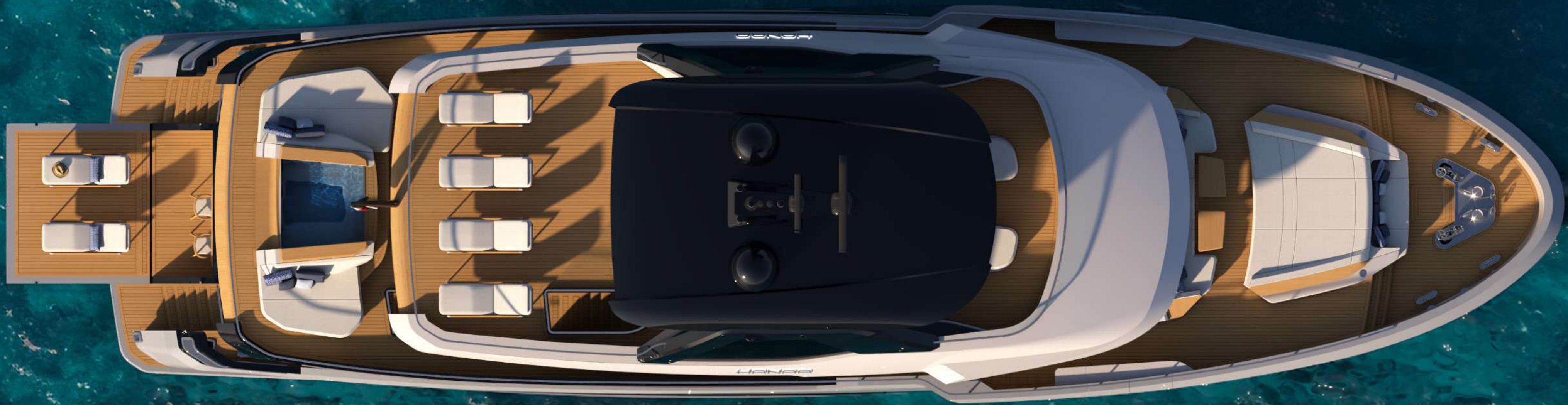

SOLD UNDER CONSTRUCTION  
**EVO-31 EXPLORER**





SOLD UNDER CONSTRUCTION  
EVO-31 EXPLORER





ANTONINI  
N A V I

ANTONINI NAVI S.R.L.

Sede legale e stabilimento:

Località Pertusola - Frazione Muggiano - 19032 Lerici (LA SPEZIA) - ITALY

Ph +39 0187 1771300

[info@antonininavi.com](mailto:info@antonininavi.com)

[www.antonininavi.com](http://www.antonininavi.com) - [www.gruppoantonini.it](http://www.gruppoantonini.it)