



ANTONINI
NAVI



FULVIO DE SIMONI
YACHT DESIGN



SUY-108
SPORT UTILITY YACHT®

SUY-108

CONCEPT



SUY-108 is a Utility Yacht® that maximizes entertainment at sea, in nature, and during adventures. Achieved through innovative design, this yacht series, though relatively short, excels in carrying numerous tenders, amenities, and toys. Exceptional space allocation, volume utilization, and handling equipment design make SUY-108 truly unique, combining the classic motoryacht aesthetics with the commanding appeal of an Expedition Yacht.

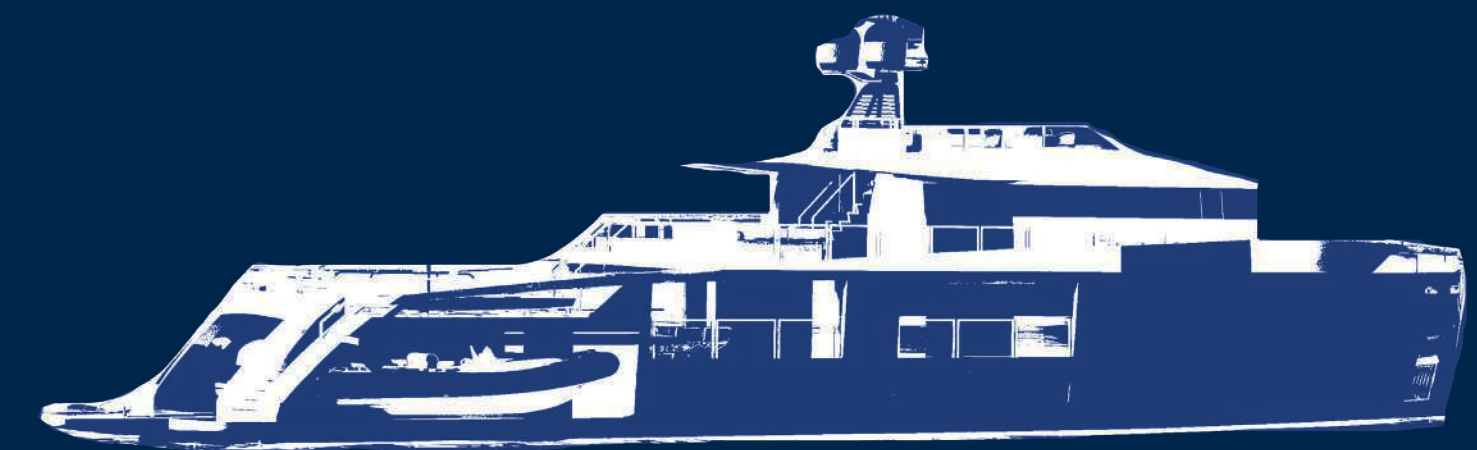

THE SUY LINE

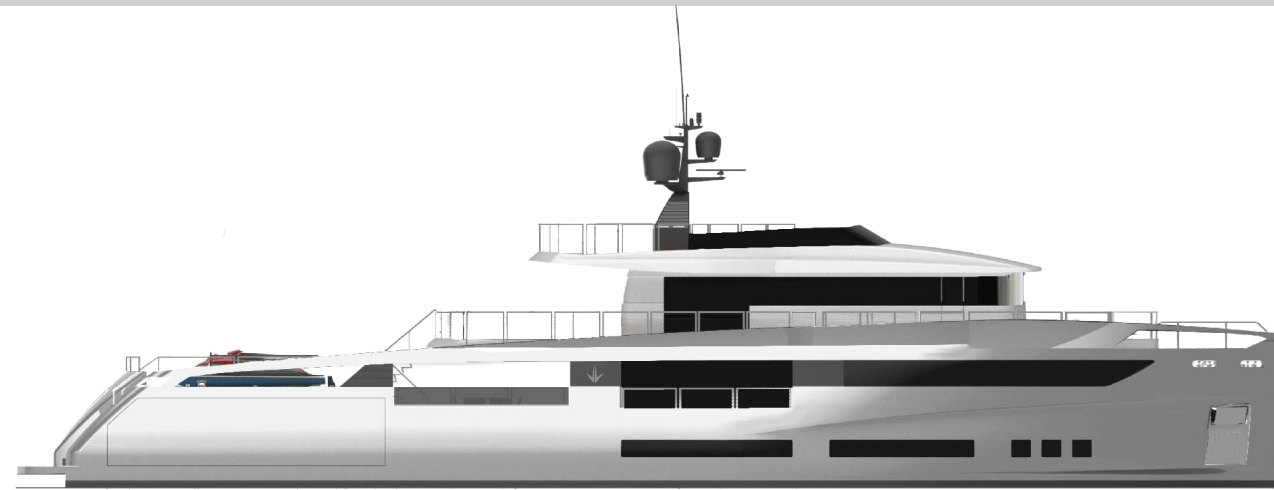

SUY-108

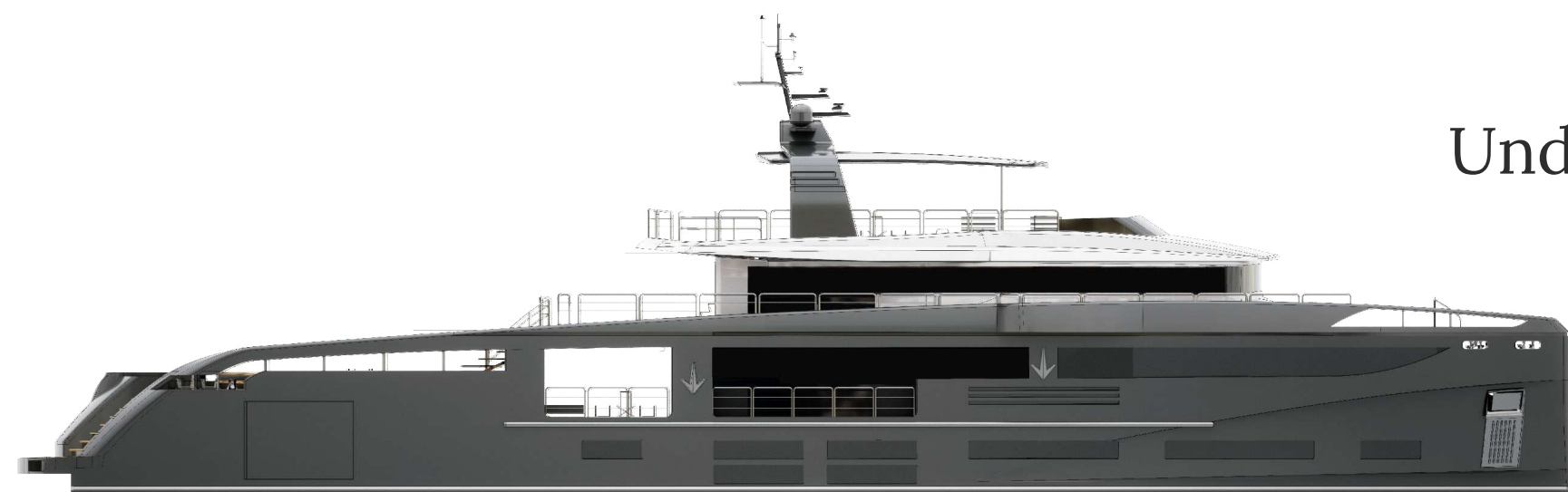

SUY-135
Under construction in spec



SUY-190

The SUY line of 'Sports Utility Yachts', was developed by Aldo Manna, Partner and Sales Director for Antonini Navi, together with Fulvio De Simoni who has designed many iconic yachts over a long-standing career.

Comprising three models, the SUY 108, SUY 135, and SUY 190, the concept seeks to fulfil the growing demand for a brand-new superyacht class with allround seafaring ability – able to sail in deep waters with comfort and luxury, but remaining in close contact with the ocean and marine life.

Sporting an innovative layout with a raised aft deck that's separated from the saloon by a lower-level veranda, more privacy is created for when the yacht's in port and, at the same time, a versatile hangar space for use as a beach club or storing additional toys.



YACHT DESIGNER
FULVIO DE SIMONI

Fulvio de Simoni initiated his career in the 1970s. Known for his multifaceted, innovative, and non-conformist design approach, he collaborated with shipyards globally and contributed to the construction of over three thousand boats, earning numerous awards.



Aldo Manna, Fulvio De Simoni, Simone Antonini

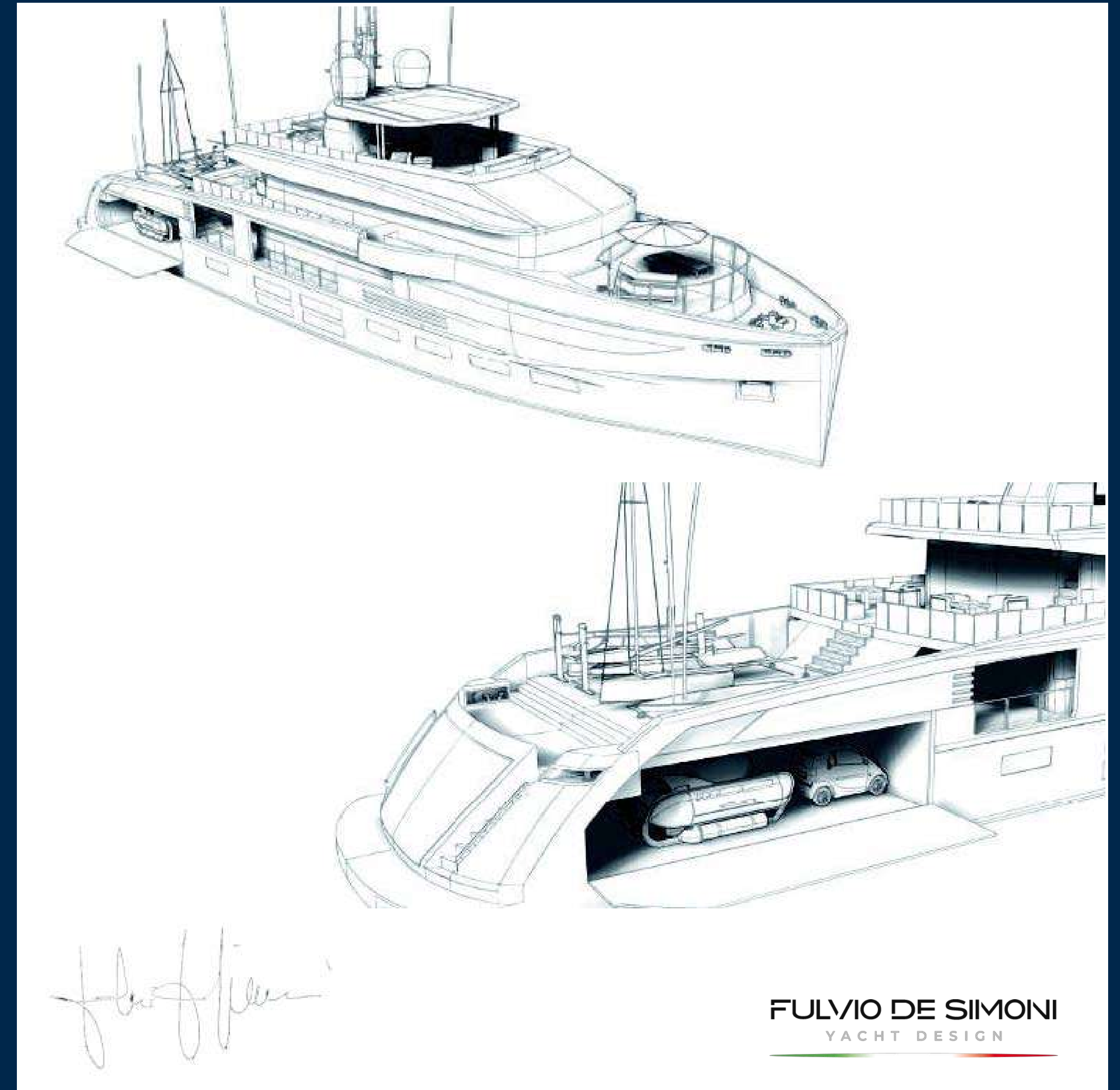

SUY-108

PROJECT

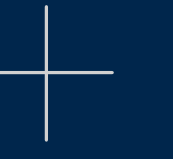

SUY-108 has a large half-raised deck, below which there is a full beam hangar that effectively allows the doubling of the storage surfaces.

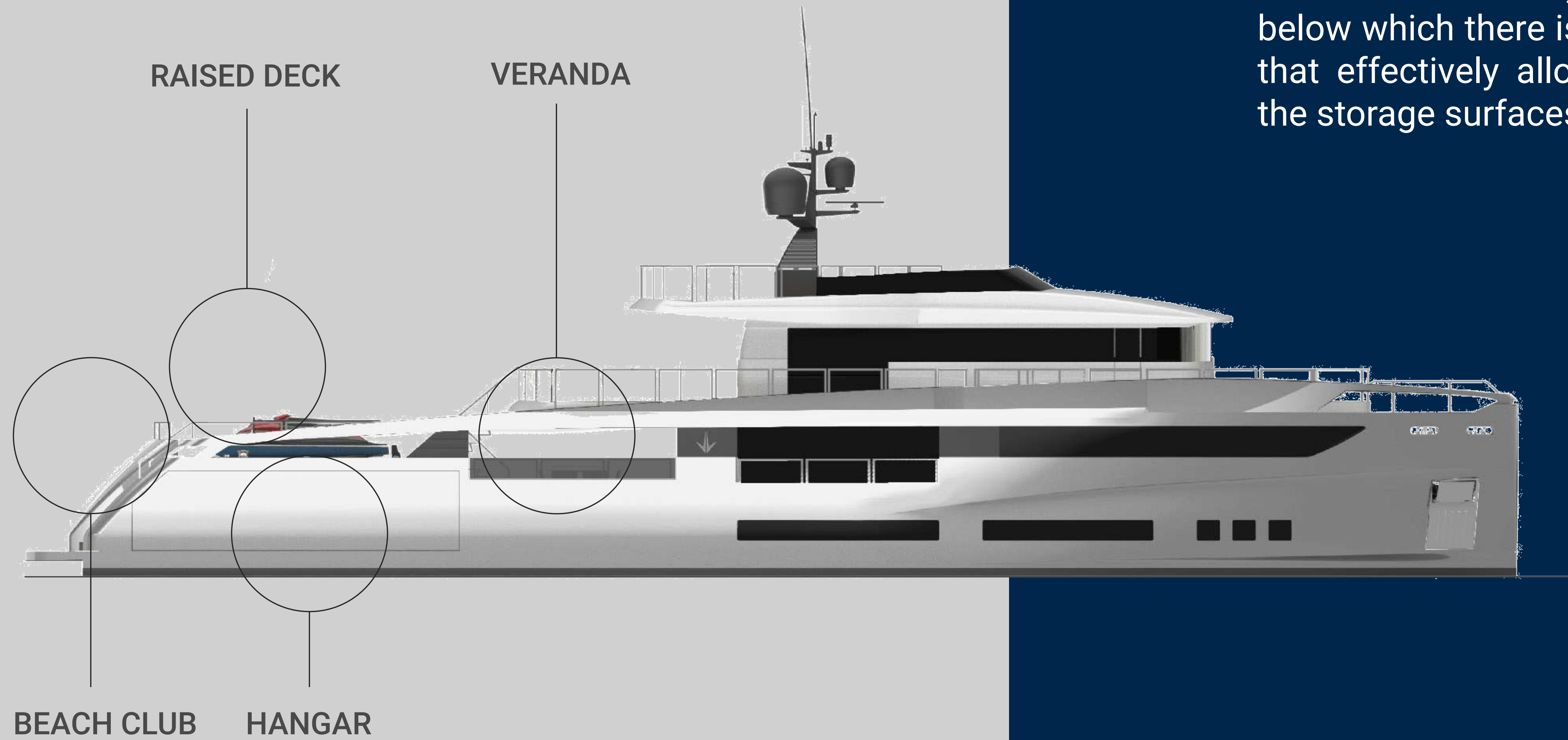

SUY-108

PROJECT

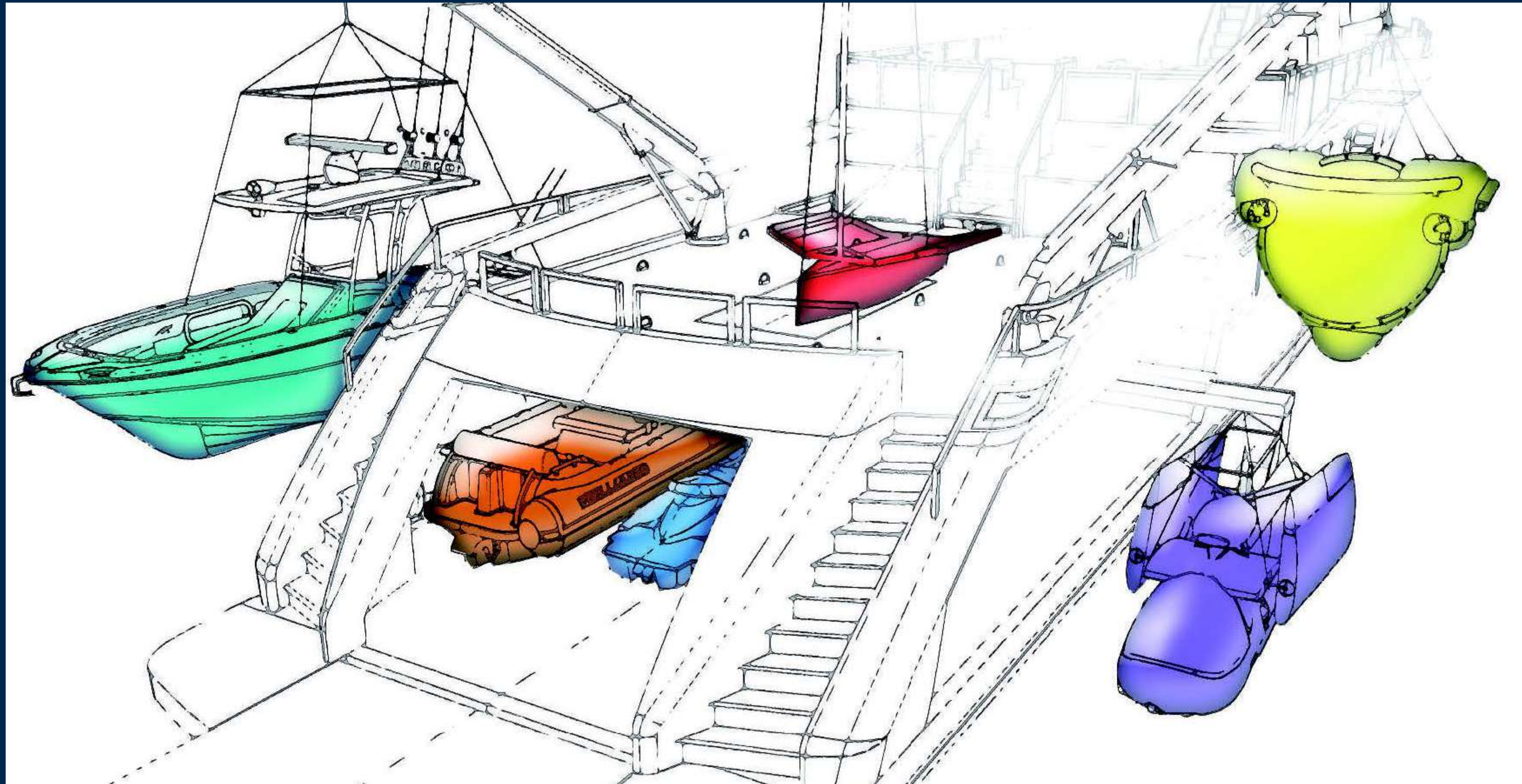

A sizable transversal tender garage stows a 7-metre RIB and leaves plenty of space for water toys.

Unique in its features, can easily embark all of the below toys and amenities simultaneously!

SUY-108

TOYS & AMENITIES

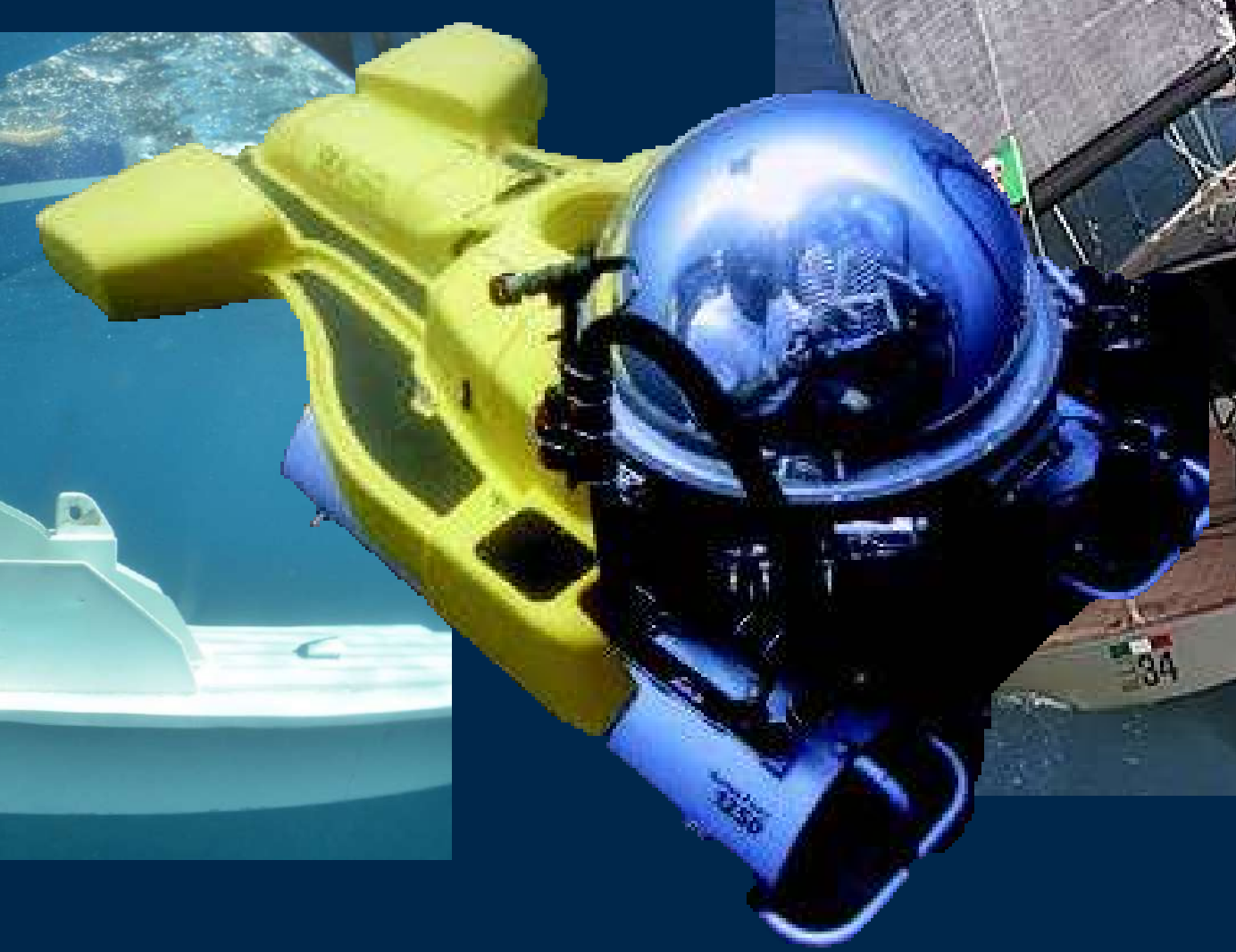
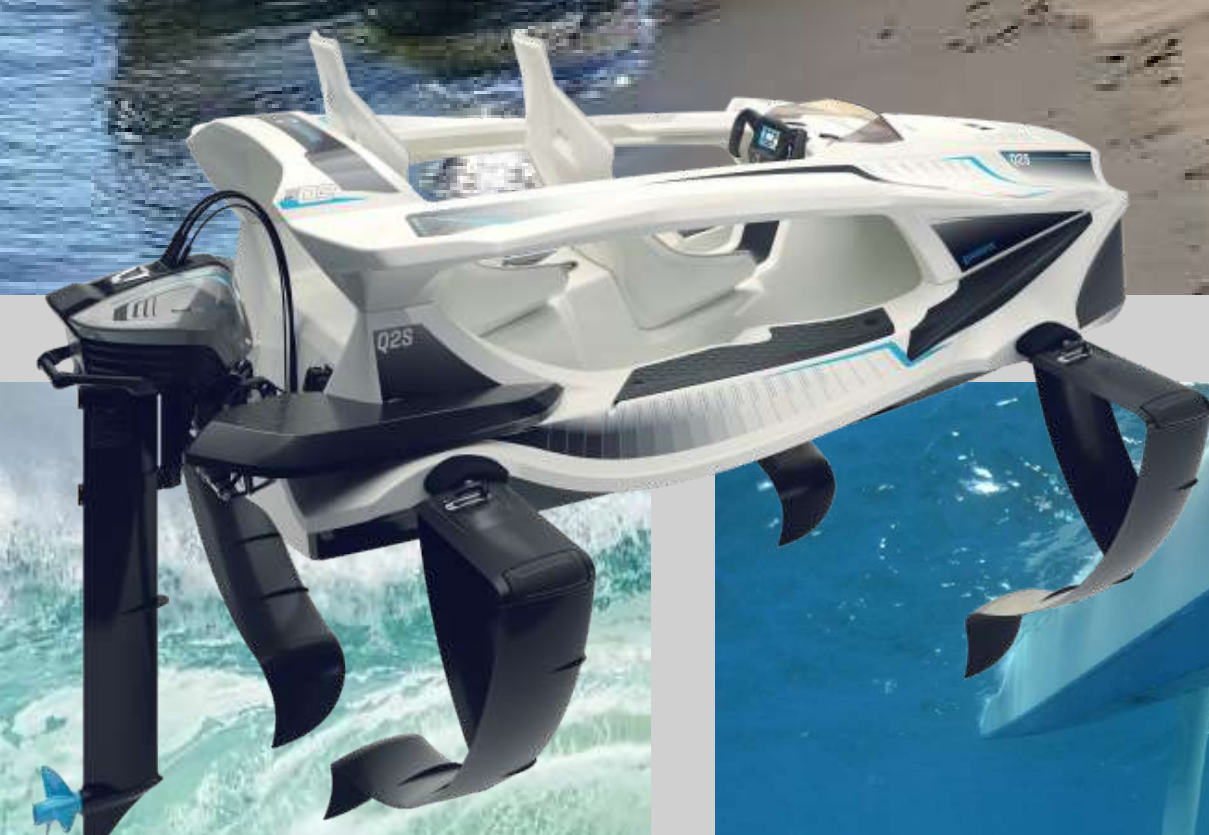
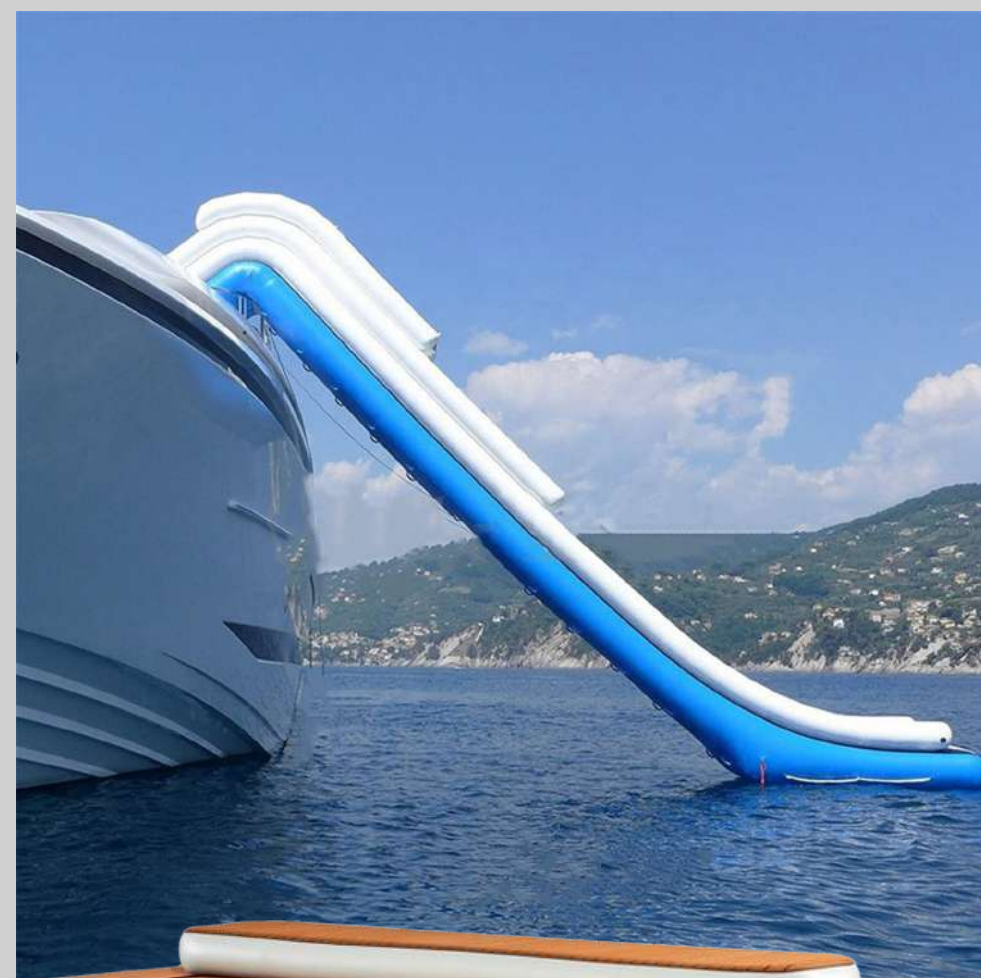

STERN



SEA

STERN



INTERIOR DESIGN

The large and well defined spaces that the SUY 108 offers are ideal for any furnishing ideas you may have.



SUY-108

INTERIORS STYLE



SUY-108

TECHNICAL SPECIFICATION

DIMENSIONS

Hull: Steel
Superstructure: Aluminium

DIMENSIONS

Length over all (LOA): 33.5 m
Waterline length: 32.5 m
Maximum beam: 7.5 m
Depth, amidship: 4.0 m
Draft at full load: 2.4 m
Gross Tonnage: <300 GT

CAPACITIES

Marine Gas Oil: 42.0 m³
Fresh Water: 6.0 m³
Black/gray water: 1.0 m³

PERFORMANCE

Cruising speed: 12.0 kts
Max Speed: 13.0 kts
Range @10 kts:..... 4.000 Miles

PROPULSION:..... 2xCat C18 2x533Kw@1800-2100rpm

ACCOMMODATION

Owner & guests accommodation:10p in 5 cabins
Crew Accommodation: 4+1p in 3 cabins

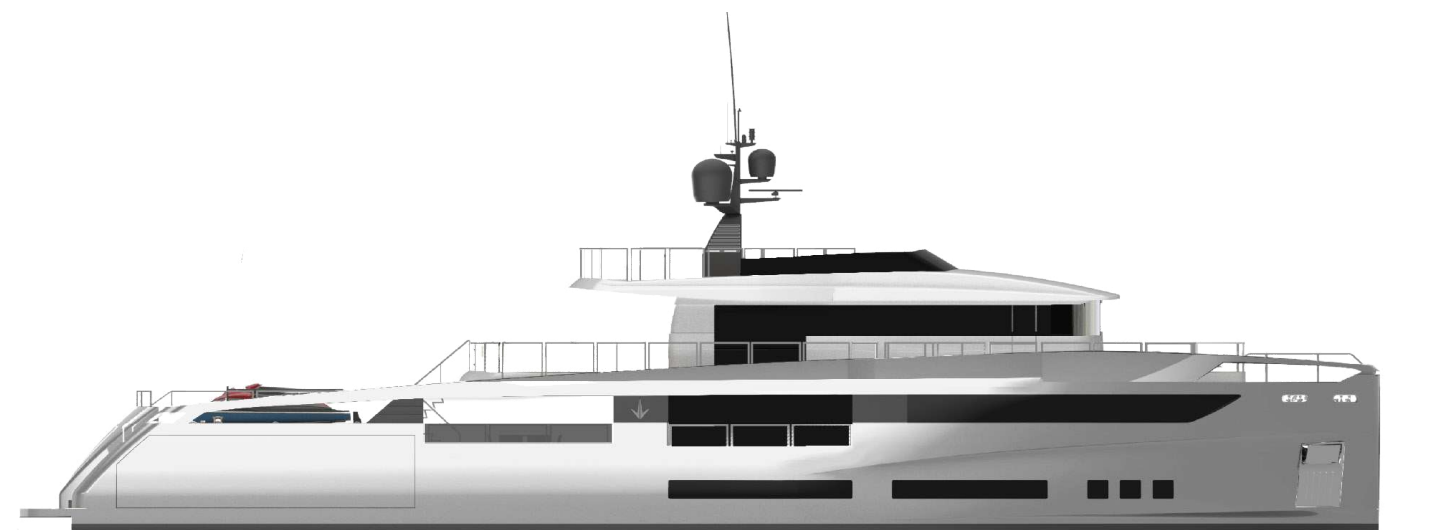

SUY-108

GENERAL ARRANGEMENT

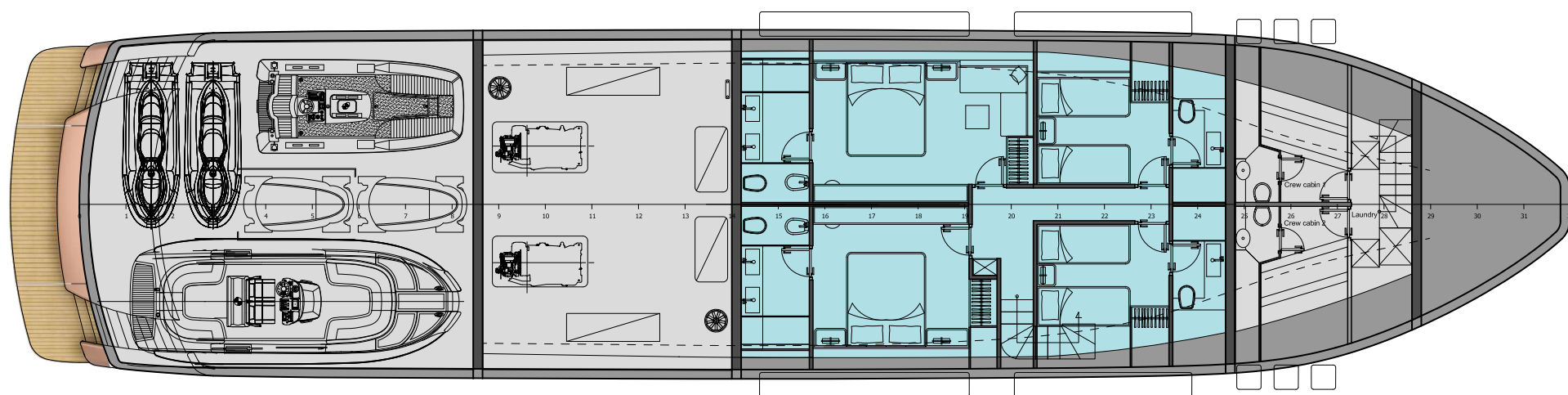
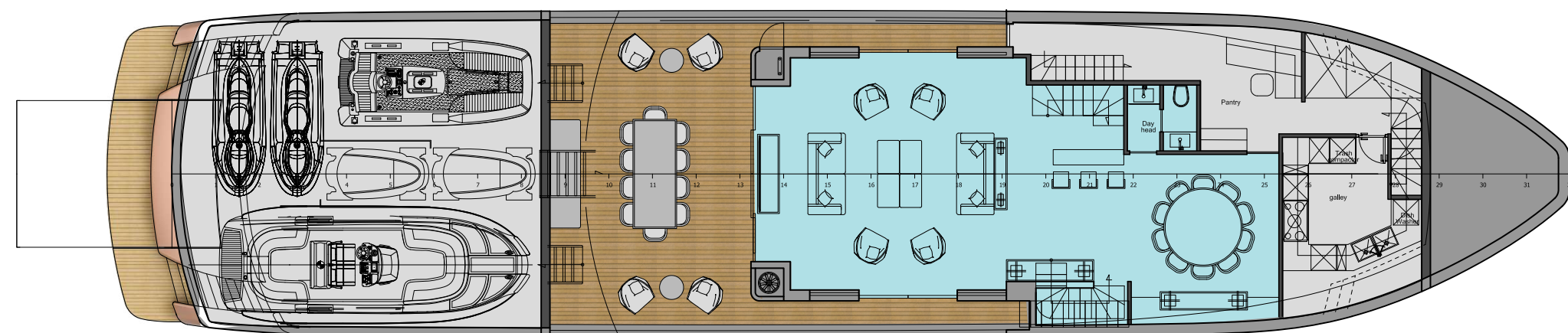
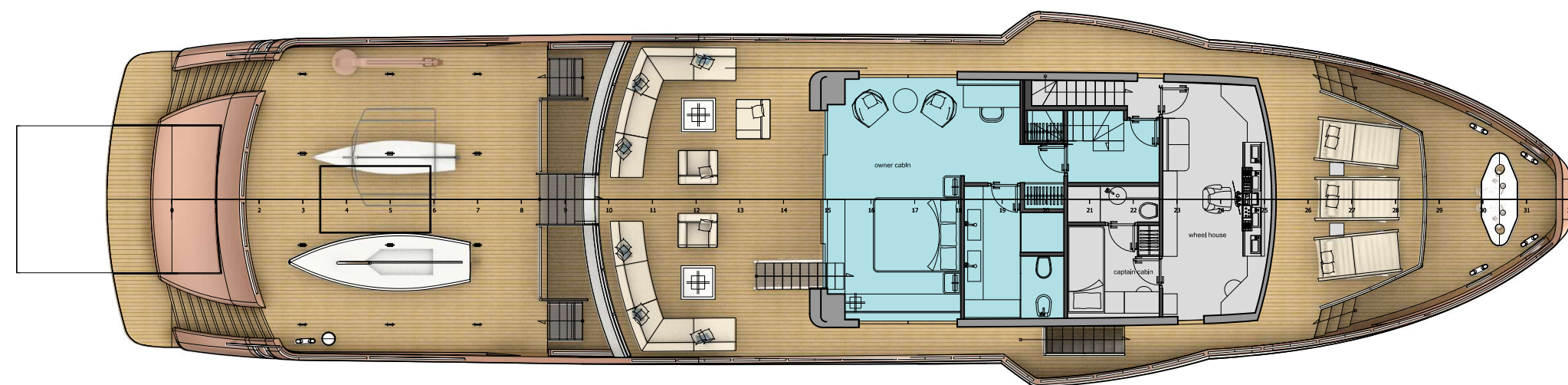
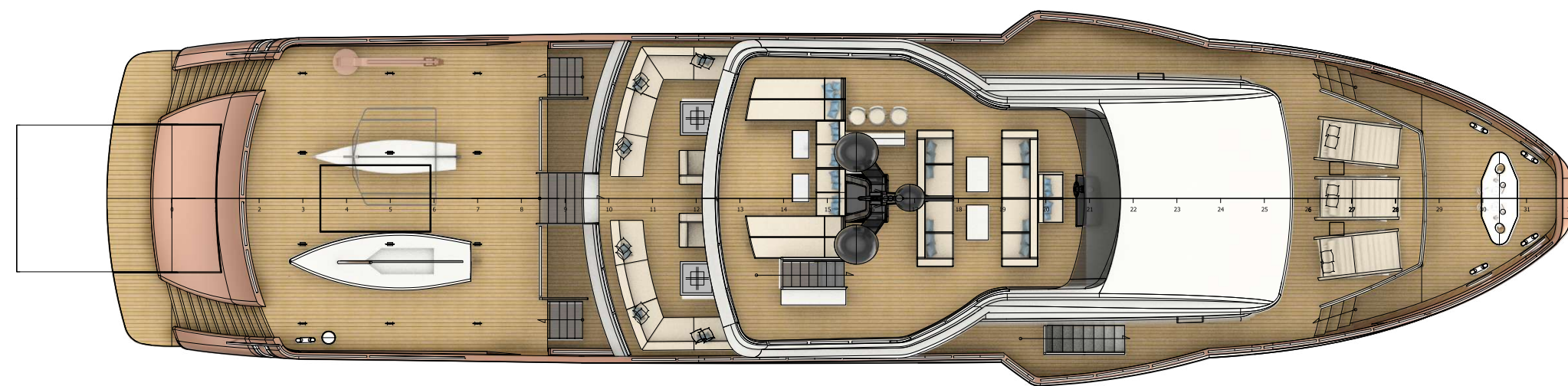

SUY-108

SUN DECK

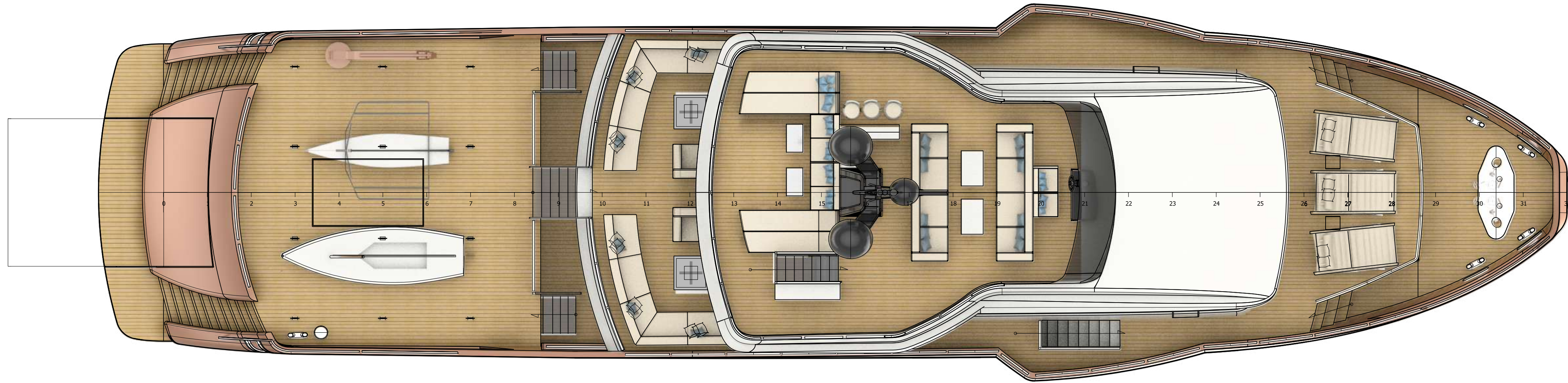

SUY-108

UPPER DECK

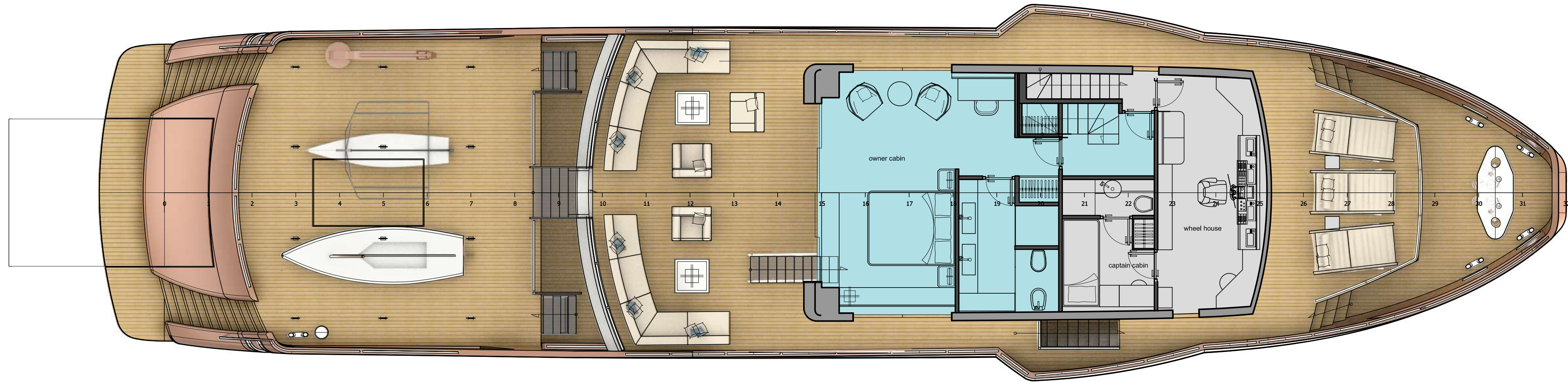

SUY-108

MAIN DECK

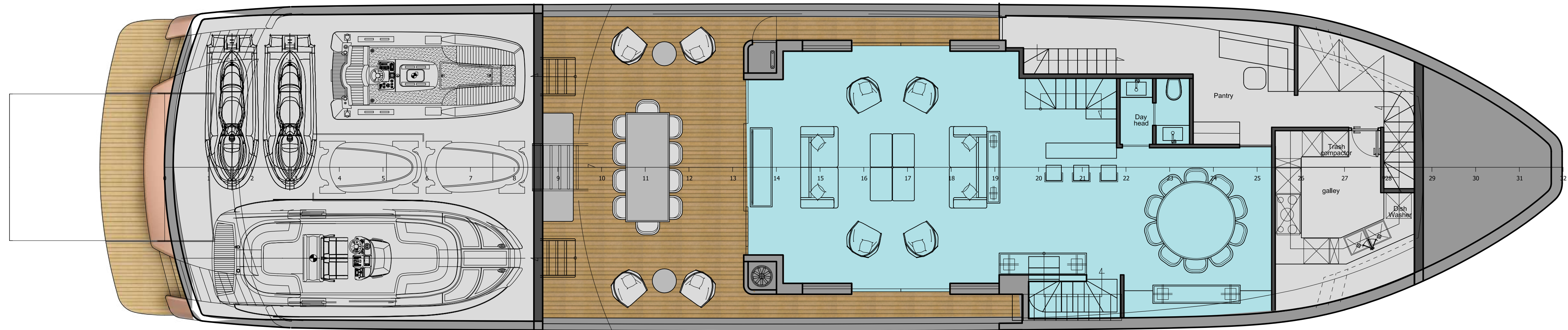

SUY-108

LOWER DECK

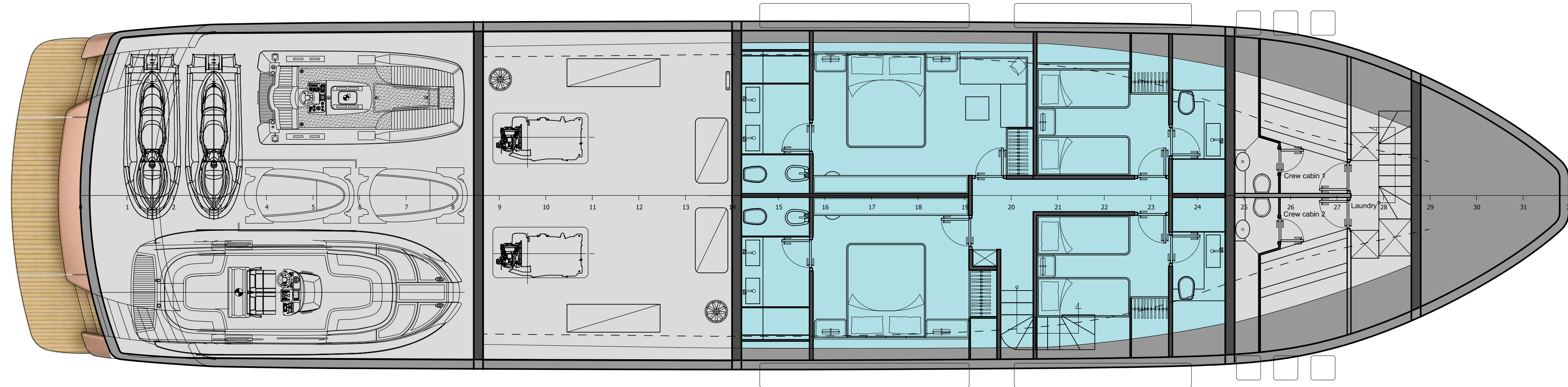



SUY-108
SPORT UTILITY YACHT®



SUY-108

SPORT UTILITY YACHT®



Moravia
YACHTING



CONTACTS

ALESSANDRO DIOMEDI

Sales Broker

+377 6 43 91 90 54 | alessandro.diomedi@moraviayachting.mc

"We are delighted to have this cooperation with Antonini Navi, a brand born under the flag of Gruppo Antonini, an Italian builder with over 70 years' experience in naval construction and the operation of offshore oil and gas field structures.

For over four years, Antonini Navi has been building hulls for other major names in luxury yachting and the launch of their own superyacht line has already seen encouraging commercial results. The SUY series is an interesting and innovative concept with big volumes and great capacity whilst, at the same time, special attention is given to the yacht owner's privacy and lifestyle." –Alessandro Diomedi, Sales Broker at Moravia Yachting



ANTONINI
N A V I

ANTONINI NAVI S.R.L.

Sede legale e stabilimento:

Località Pertusola - Frazione Muggiano - 19032 Lerici (LA SPEZIA) - ITALY

Ph +39 0187 1771300

info@antonininavi.com

www.antonininavi.com - www.gruppoantonini.it